

Data sheet - Push-in fitting QS-H-3/8-1/4-U-M - 533222

Function

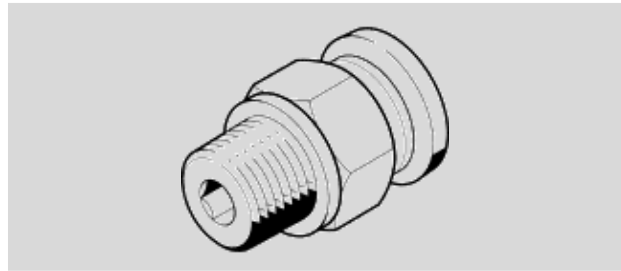

Feature	values
Size	Standard
Nominal size	4.2 mm
Type of seal on screw-in stud	coating
Working pressure	-0.95 - 10 bar
Ambient temperature	0 - 60 °C
Authorization	Germanischer Lloyd
Max. tightening torque	22 Nm
Product weight	26.5 g